

Innovative High Schools - Arts



Arts Concepts

- ✓ Creative expression
- ✓ Exploration
- ✓ Performance
- ✓ Emotional wellness
- ✓ Flexible / multi-use
- ✓ Passion & purpose
- ✓ Fosters social & interpersonal skills
- ✓ Talent and skill development
- ✓ Community engagement and use



Hampton High School | DRAW Collective

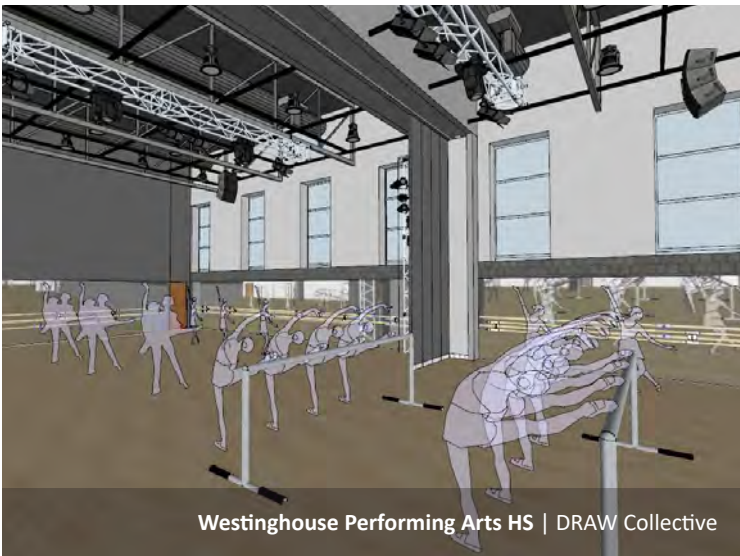

Westinghouse Performing Arts HS | DRAW Collective



Pine-Richland School District | DRAW Collective



Forest Hills Jr/Sr High School | DRAW Collective

STUDENT ENRICHMENT

We know that the performing and fine arts programs need top notch facilities including a specialized arts studios, black box theater, an auditorium with stage, and music, orchestra, and band areas. These highly specialized facilities not only support student interests and varied learning styles but also help bring the community to the school for performances and events. A building that showcases student creations represents the innovative programs being delivered.

Our empathetic approach to design and our rich history of design for education provide us with a unique ability to design for the varied users of these types of spaces. Offering students experiences to not only practice their craft but showcase their talents is critical to a rich student experience.

The design for public participation in these spaces is a significant contributor to the overall design of these areas. Generous lobbies, adjacent parking, clear wayfinding, and adequate support facilities that can be operated for after school events is key to a successful design.